



### Features:

- AC input: 100 ~ 264Vac
- Built-in Active PFC, PF>0.95
- Withstand input 300Vac for 60s
- High efficiency, long life and high reliability
- Output protections: OCP/SCP/OPP/OTP
- Wide operating ambient temperature (-40°C~60°C)
- No fan suitable for quiet environment
- 100% full load burn-in test
- PCB with conformal coating
- 3 years warranty

### SPECIFICATION

MODEL		VAT-UP200-5-G	
OUTPUT	DC Output		5V
	Rated Current		50A
	Current Range		Note 1 0~50A
	Ripple and Noise	0~55°C	≤150mV
		Note 2 -40~0°C	≤400mV
	Voltage Accuracy		4.9~5.2V
	Line Regulation		4.9~5.2V
	Load Regulation		4.9~5.2V
	Set-up Time		≤2.0S (220Vac input, Full load)
	Hold up Time		≥5mS(220Vac input, load 32A)
	Temperature Coefficient		±0.03%/°C
Overshoot and Undershoot		<±5%	
INPUT	Voltage Range		100Vac~264Vac
	Frequency Range		47Hz~63Hz
	Efficiency ( Typical)		88%(220Vac input ,load 50A)
	AC Current (max.)		<3.5A
	Inrush Current (Typical)		<60A@220Vac Cold start
	Power factor		>0.95(220Vac input ,40A)
	Standby power		<4W
	Leakage Current		Input—output: ≤0.25mA Input—PG: ≤3.5mA (264Vac input, 63Hz)
PROTECTION	Over Power		225~300W @ 100~170Vac input; 275~300W @ 180~264Vac, Hiccup, auto recovery
	Over Current		45A-60A @100-170Vac; 55-70A @ 180-264Vac, Hiccup, auto recovery
	Shorted Circuit		Long-term mode, auto recovery
	Over Temperature		115°C+5°C (detect on PFC inductance);shut down, auto recovery after the temperature goes down
ENVIRONMENT	Operating amb. Temp. & Hum.		-40°C~60°C; 20%~90%RH No condensing (refer to the derating curve)
	Storage Temp. & Hum.		-40°C~85°C; 10%~95%RH No condensing
SAFETY & EMC Note 3	Safety Standards		UL60950-1 2nd Ed; IEC 60950-1:2005(2nd Ed) ;EN60950-1:2006
	Withstand Voltage		Primary-Secondary: 3.0KVac/10mA .Primary-PG:1.5KVac/10mA. Secondary-PG: 0.5KVDC/10mA.
	Isolation Resistance		10M ohms
	EMI Conduction & Radiation		Compliance to EN55022 Class B
	Harmonic Current		Compliance to EN61000-3-2, CLASS D
OTHERS	EMS Immunity		Compliance to EN61000-4-2,3,4,5,6,8,11;
	MTBF (MIL-HDBK-217F)		More than 200,000Hrs (25°C, Full load)
	Dimension (L*W*H)		145*60*30mm
	Packing		36pcs/CTN
Cooling method		Free air convection	

NOTE

1. All parameters NOT specially mentioned are measured at rated input, rated load and 25°C of ambient temperature.
2. Measured at 100MHz of bandwidth by using a 12" twisted pair-wire terminated with a 0.1 uF & 100uF parallel capacitor.
3. The SPS is considered a component which will be installed into final equipment. The equipment must be re-confirmed that it still meets EMC directives.

■ Mechanical Specification

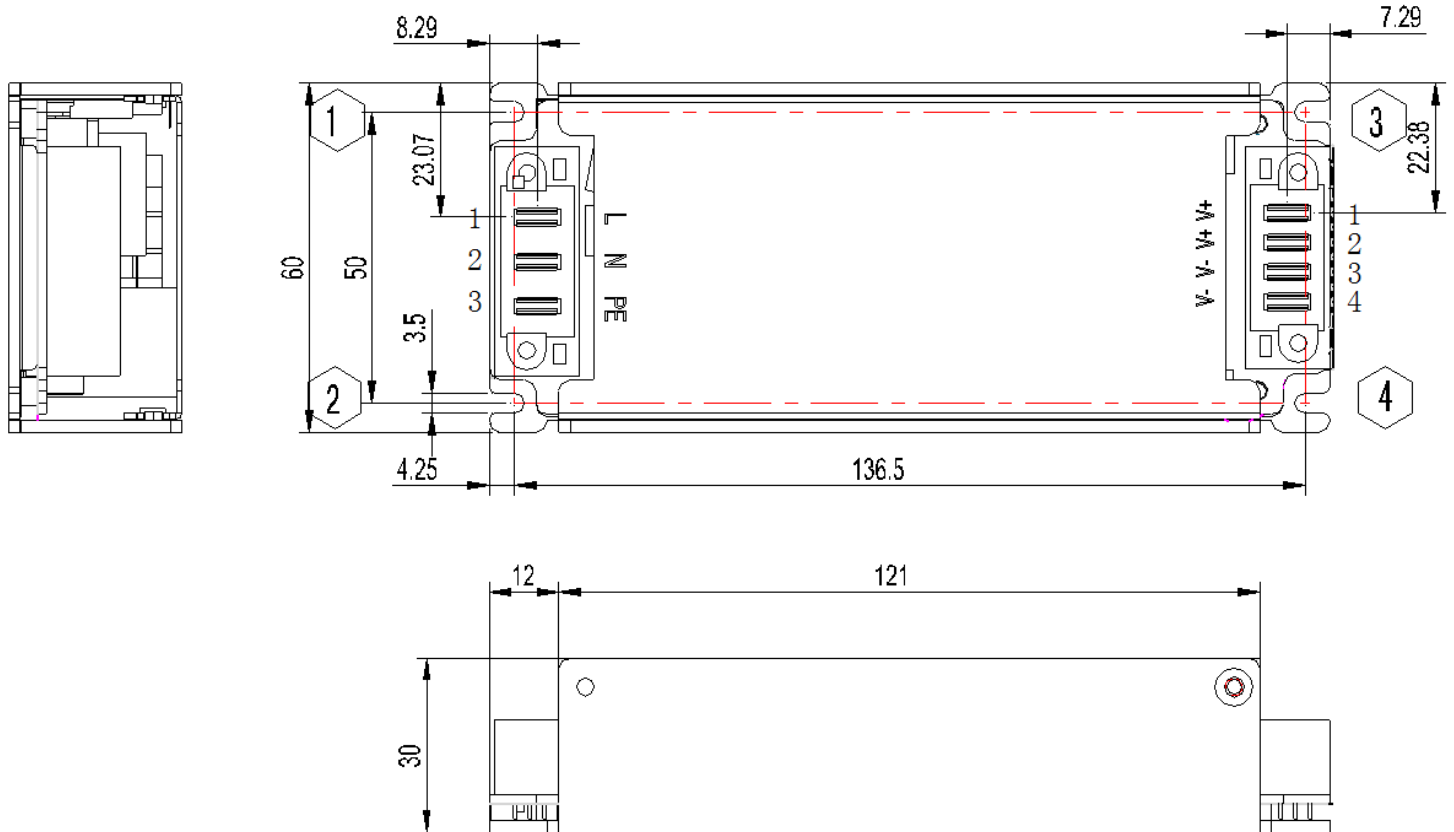

Mounting Position	Mounting Method	Mounting Holes	Screw Specs	Lmax	Torque max
Bottom	Screw	1~4	M3	4mm	6Kgf.cm

1. AC connector

No.	Function	Specs
1	L	JYP-M0003D-VT41R
2	N	
3	PE	

2. DC connector

No.	Function	Specs
1	V+	JYP-M0003D-VT41R
2		
3	V-	
4		

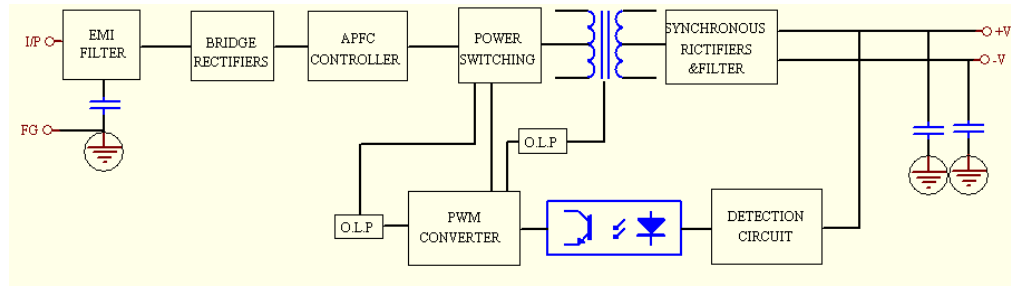
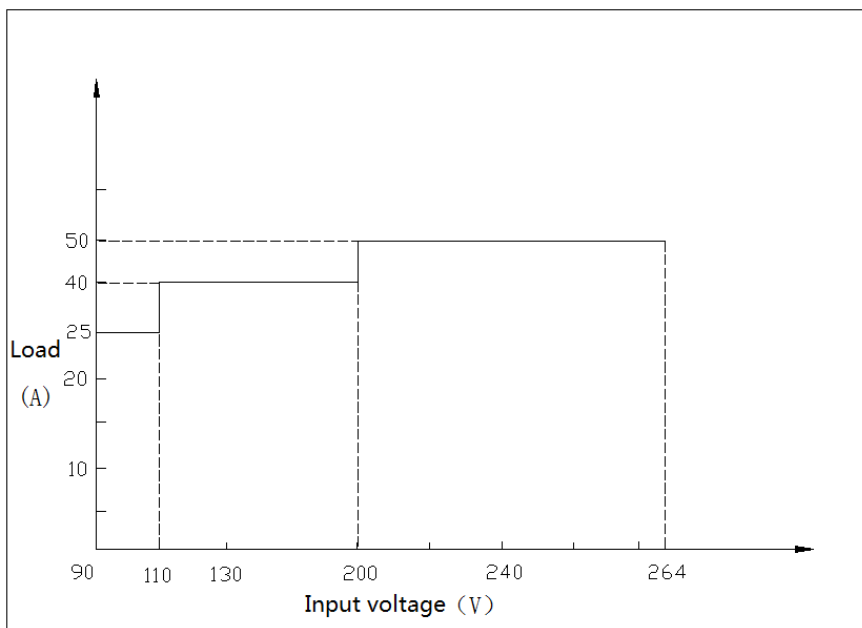
**Block Diagram**

**Derating Curve (PSU fixed to aluminum heat-sink of 500mm\*500mm\*3mm)**
**1. Load current—Input voltage Curve**

**2. Load current—Ambient temperature Curve**
