

# PDD10-48D Series

## 10 Watt Dual Outputs

### Features

- Approved to IEC/EN60950, UL60950 safety standards
- Industry standard footprint:  
2" x 1" x 0.4" (50.80 x 25.40 x 10.16mm<sup>3</sup>)
- Typical efficiency: 81%
- Wide input voltage: 36-75V
- Dual outputs: +/-5V, +/-12V, +/-15V
- Remote control
- No minimum load requirement
- Output over-current protection (for +/-5V)
- Isolation voltage: 1500Vdc, 1min (Input-Output; Input-Case; Output-Case)

### Environmental

- Operating ambient temperature range:  
-40 to 55
- Operating case temperature range:  
-40 to 100
- Storage temperature:  
-55 to 125
- Temp.coefficient:  
<math>\pm 0.02\%/</math>
- MTBF:  
>2 million hrs

### Electrical Specifications

#### Input

Input range: 36-75Vdc

#### Output

Voltage setpoint accuracy:  $\pm 1.0\%V_o$  max.

Line regulation:  $0.2\%V_o$  max.

Load regulation:  $0.5\%V_o$  max.

Over-current protection: continuous, auto-recovery

Ripple and noise: <math>< 50\text{mVpp}</math> max.

Transient response: 200mV max.

recovery <math>< 200\mu\text{S}</math> max.

(25% step load change from 50%  $I_o$ )

di/dt: 1A/10uS

#### Control

Control voltage:

Positive logic

High =on 3.5 to 10Vdc

Low=off -0.7 to 0.8Vdc

Negative logic

Low =on -0.7 to 0.8Vdc

High=off 3.5 to 10Vdc

Control current: 2mA max. (for positive logic)

4mA max. (for negative logic)



## Ordering Information

Input Voltage	Output Voltage	Output Current	Efficiency	Model Number
48V	+/-5V	1A	81%	PDD10-48D05
48V	+/-12V	0.42A	83%	PDD10-48D12
48V	+/-15V	0.33A	84%	PDD10-48D15

## Dimensions

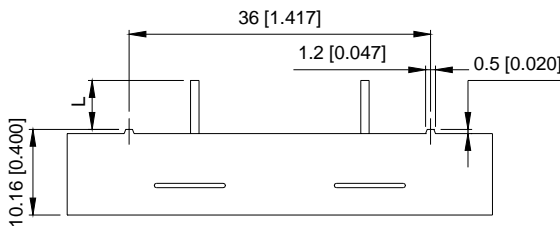
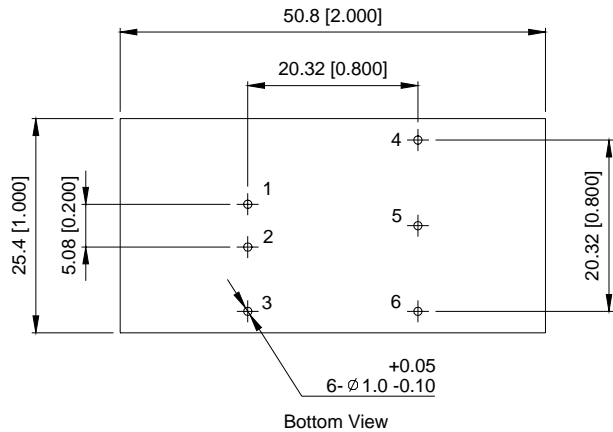

TOLERANCES: X.Xmm=+/-0.5mm  
X.XXmm=+/-0.25mm

Unit:mm[inch]

Notes: The detail and recommended hole pattern layout is available in the Application Manual.

## Pin Assignments

1	+Vin
2	-Vin
3	CNT
4	+Vo
5	COM
6	-Vo

Pin Length: 5.8mm